



# Round Post Glass Railing



# Prefabricated Railing Assemblies for Glass Panel

Post assemblies simplify installation and eliminate welding.

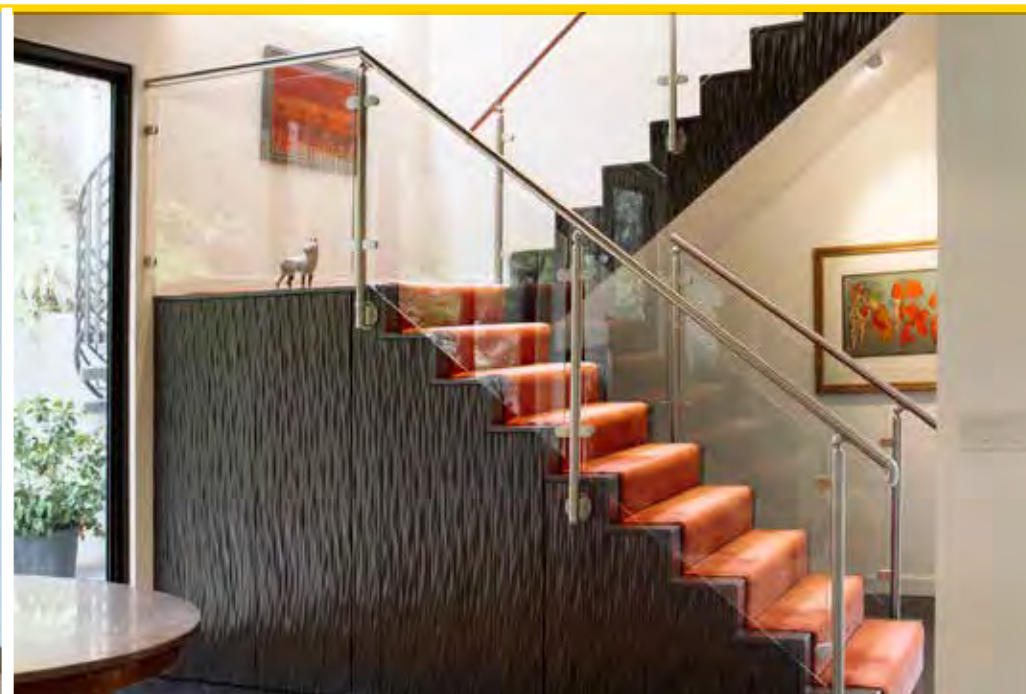

**ADJUSTABLE!**



## A custom look that installs in minutes.

Prefabricated Glass Panel Railing posts will save you time and money. Just choose from the many customizable options and let us build them for you. All you need to do is mount the posts and attach the glass. It couldn't be more simple!

## Complete your project with matching components.

It's easy to finish off your railing project with the perfect handrail. Our beautiful polished or satin 316 stainless steel tubing can be customized with a variety of end caps to complete your railing project.

## Prefabricated Post Options

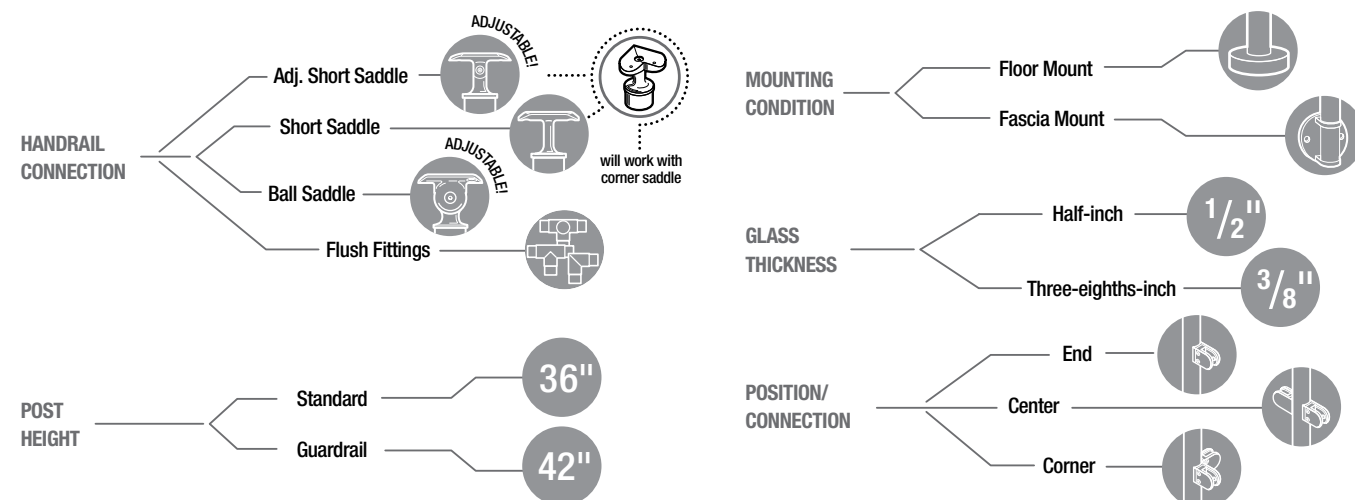

Our flush fittings extend the available applications of Glass Panel projects. Angled and adjustable fittings allow you to turn corners and navigate stairs in style.

Add the finishing touch to your railing project with Metal Polish. It cleans, polishes and protects polished metals with its anti-tarnish formula. And for a weld-free installation, use Loctite 326 structural adhesive for a secure, permanent bond between component pieces.



*Fascia-mount option shown with adjustable saddle handrail connection. Floor-mount option shown with fixed saddle corner connection. Many more options available.*

# Prefabricated Posts for Glass: (Round) 36" Standard

# 42" Guardrail (Round)

## Short Adjustable Saddle



## Short Saddle (non-adjustable)



MOUNTING CONDITION	AVAILABLE FINISHES	ITEM #	GLASS THICKNESS	POSITION/ CONNECTION	POST DIAMETER
--------------------	--------------------	--------	-----------------	----------------------	---------------

MOUNTING CONDITION	AVAILABLE FINISHES	ITEM #	GLASS THICKNESS	POSITION/ CONNECTION	POST DIAMETER
--------------------	--------------------	--------	-----------------	----------------------	---------------

## Short Adjustable Saddle



## Short Saddle (non-adjustable)



MOUNTING CONDITION	AVAILABLE FINISHES	ITEM #	GLASS THICKNESS	POSITION/ CONNECTION	POST DIAMETER
--------------------	--------------------	--------	-----------------	----------------------	---------------

MOUNTING CONDITION	AVAILABLE FINISHES	ITEM #	GLASS THICKNESS	POSITION/ CONNECTION	POST DIAMETER
--------------------	--------------------	--------	-----------------	----------------------	---------------

	Satin	GC/4S/EN/36/AR/FL	3/8"	End	1.67"
	Satin	GC/4S/CN/36/AR/FL	3/8"	Center	1.67"

	Satin	GC/4S/EN/36/FR/FL	3/8"	End	1.67"
	Satin	GC/4S/CN/36/FR/FL	3/8"	Center	1.67"
	Satin	GC/4S/CR/36/FR/FL	3/8"	Corner	1.67"

	Satin	GC/4S/EN/42/AR/FL	3/8"	End	1.67"
	Satin	GC/4S/CN/42/AR/FL	3/8"	Center	1.67"

	Satin	GC/4S/EN/42/FR/FL	3/8"	End	1.67"
	Satin	GC/4S/CN/42/FR/FL	3/8"	Center	1.67"
	Satin	GC/4S/CR/42/FR/FL	3/8"	Corner	1.67"

	Satin	GC/4S/EN/36/AR/FM	3/8"	End	1.67"
	Satin	GC/4S/CN/36/AR/FM	3/8"	Center	1.67"

	Satin	GC/4S/EN/36/FR/FM	3/8"	End	1.67"
	Satin	GC/4S/CN/36/FR/FM	3/8"	Center	1.67"

	Satin	GC/4S/EN/42/AR/FM	3/8"	End	1.67"
	Satin	GC/4S/CN/42/AR/FM	3/8"	Center	1.67"

	Satin	GC/4S/EN/42/FR/FM	3/8"	End	1.67"
	Satin	GC/4S/CN/42/FR/FM	3/8"	Center	1.67"

	Satin	GC/4S/EN/36/AR/CD	3/8"	End	1.67"
	Satin	GC/4S/CN/36/AR/CD	3/8"	Center	1.67"

	Satin	GC/4S/EN/36/FR/CD	3/8"	End	1.67"
	Satin	GC/4S/CN/36/FR/CD	3/8"	Center	1.67"

	Satin	GC/4S/EN/42/AR/CD	3/8"	End	1.67"
	Satin	GC/4S/CN/42/AR/CD	3/8"	Center	1.67"

	Satin	GC/4S/EN/42/FR/CD	3/8"	End	1.67"
	Satin	GC/4S/CN/42/FR/CD	3/8"	Center	1.67"

All posts also available in polished 316 stainless steel.

All posts also available in polished 316 stainless steel.

All posts also available in polished 316 stainless steel.

All posts also available in polished 316 stainless steel.

Center and End

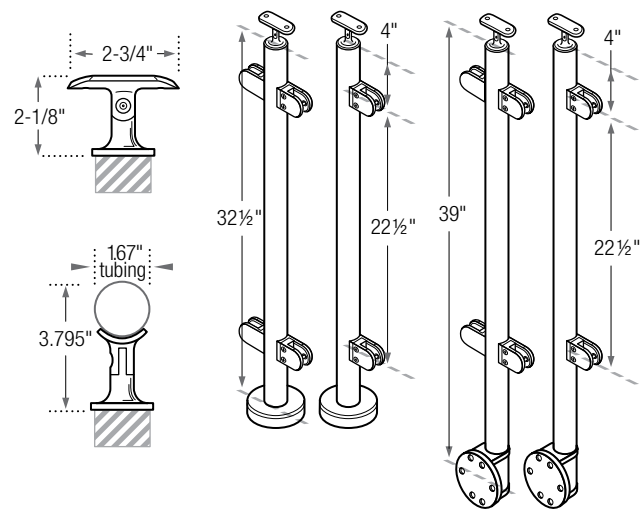

Center, Corner\* and End

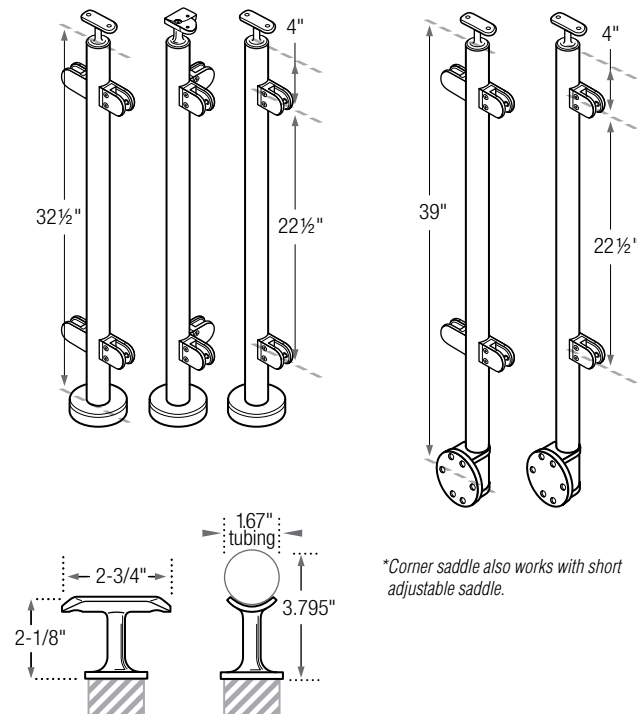

\*Corner saddle also works with short adjustable saddle.

Center and End

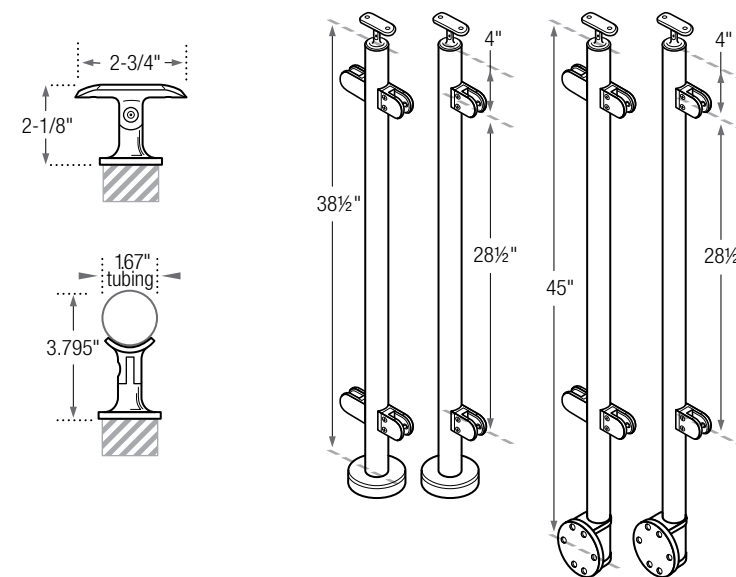

Center, Corner\* and End

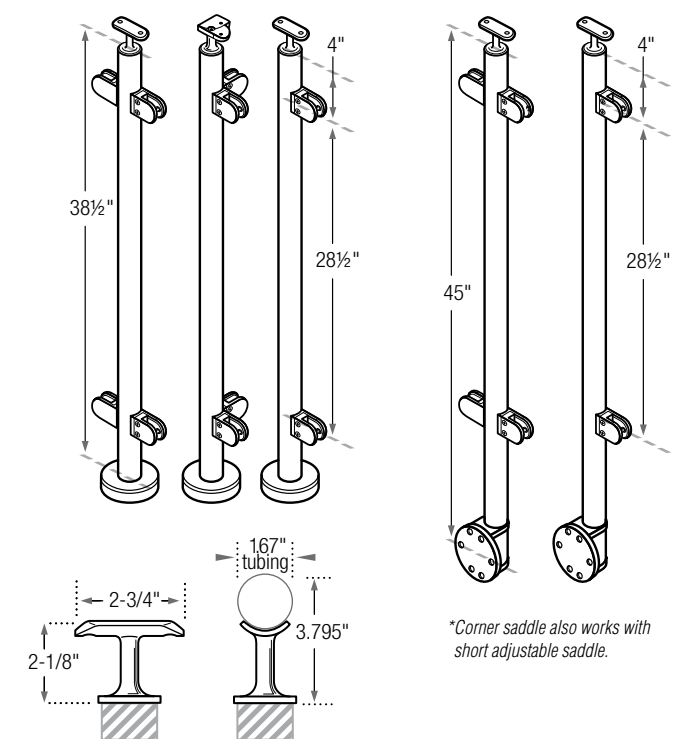

\*Corner saddle also works with short adjustable saddle.

# Prefabricated Posts for Glass: (Flat)

## 36" Standard

### Short Adjustable Saddle



### Short Saddle (non-adjustable)



MOUNTING CONDITION	AVAILABLE FINISHES	ITEM #	GLASS THICKNESS	POSITION/ CONNECTION	POST DIAMETER
--------------------	--------------------	--------	-----------------	----------------------	---------------

MOUNTING CONDITION	AVAILABLE FINISHES	ITEM #	GLASS THICKNESS	POSITION/ CONNECTION	POST DIAMETER
--------------------	--------------------	--------	-----------------	----------------------	---------------

	Satin	GC/4S/EN/36/AF/FL	3/8"	End	1.67"
	Satin	GC/4S/CN/36/AF/FL	3/8"	Center	1.67"

	Satin	GC/4S/EN/36/FF/FL	3/8"	End	1.67"
	Satin	GC/4S/CN/36/FF/FL	3/8"	Center	1.67"
	Satin	GC/4S/CR/36/FF/FL	3/8"	Corner	1.67"

	Satin	GC/4S/EN/36/AF/FM	3/8"	End	1.67"
	Satin	GC/4S/CN/36/AF/FM	3/8"	Center	1.67"

	Satin	GC/4S/EN/36/FF/FM	3/8"	End	1.67"
	Satin	GC/4S/CN/36/FF/FM	3/8"	Center	1.67"

	Satin	GC/4S/EN/36/AF/CD	3/8"	End	1.67"
	Satin	GC/4S/CN/36/AF/CD	3/8"	Center	1.67"

	Satin	GC/4S/EN/36/FF/CD	3/8"	End	1.67"
	Satin	GC/4S/CN/36/FF/CD	3/8"	Center	1.67"

All posts also available in polished 316 stainless steel.

All posts also available in polished 316 stainless steel.

### Short Adjustable Saddle



### Short Saddle (non-adjustable)



MOUNTING CONDITION	AVAILABLE FINISHES	ITEM #	GLASS THICKNESS	POSITION/ CONNECTION	POST DIAMETER
--------------------	--------------------	--------	-----------------	----------------------	---------------

MOUNTING CONDITION	AVAILABLE FINISHES	ITEM #	GLASS THICKNESS	POSITION/ CONNECTION	POST DIAMETER
--------------------	--------------------	--------	-----------------	----------------------	---------------

	Satin	GC/4S/EN/42/AF/FL	3/8"	End	1.67"
	Satin	GC/4S/CN/42/AF/FL	3/8"	Center	1.67"

	Satin	GC/4S/EN/42/FF/FL	3/8"	End	1.67"
	Satin	GC/4S/CN/42/FF/FL	3/8"	Center	1.67"
	Satin	GC/4S/CR/42/FF/FL	3/8"	Corner	1.67"

	Satin	GC/4S/EN/42/AF/FM	3/8"	End	1.67"
	Satin	GC/4S/CN/42/AF/FM	3/8"	Center	1.67"

	Satin	GC/4S/EN/42/FF/FM	3/8"	End	1.67"
	Satin	GC/4S/CN/42/FF/FM	3/8"	Center	1.67"

	Satin	GC/4S/EN/42/AF/CD	3/8"	End	1.67"
	Satin	GC/4S/CN/42/AF/CD	3/8"	Center	1.67"

	Satin	GC/4S/EN/42/FF/CD	3/8"	End	1.67"
	Satin	GC/4S/CN/42/FF/CD	3/8"	Center	1.67"

All posts also available in polished 316 stainless steel.

All posts also available in polished 316 stainless steel.

Center and End

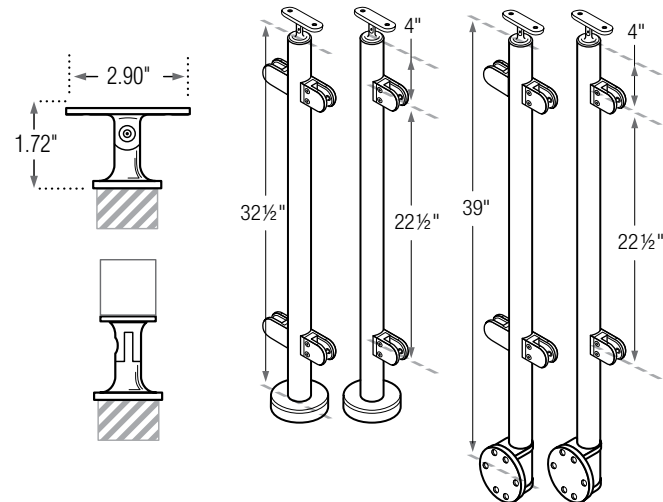

Center, Corner\* and End

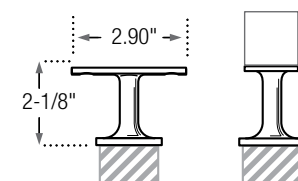
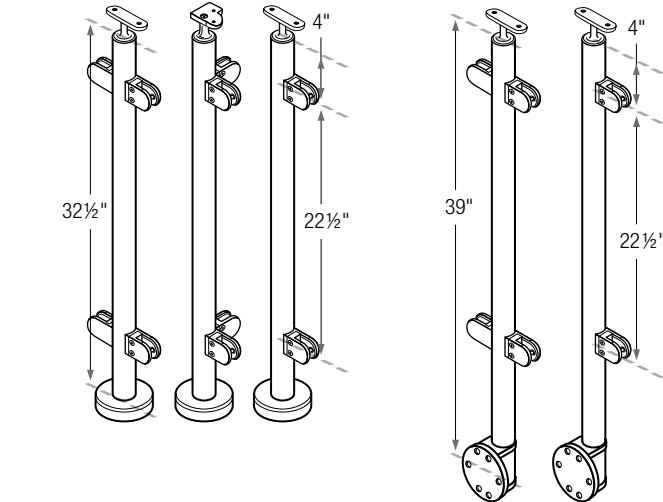

\*Corner saddle also works with short adjustable saddle.

Center and End

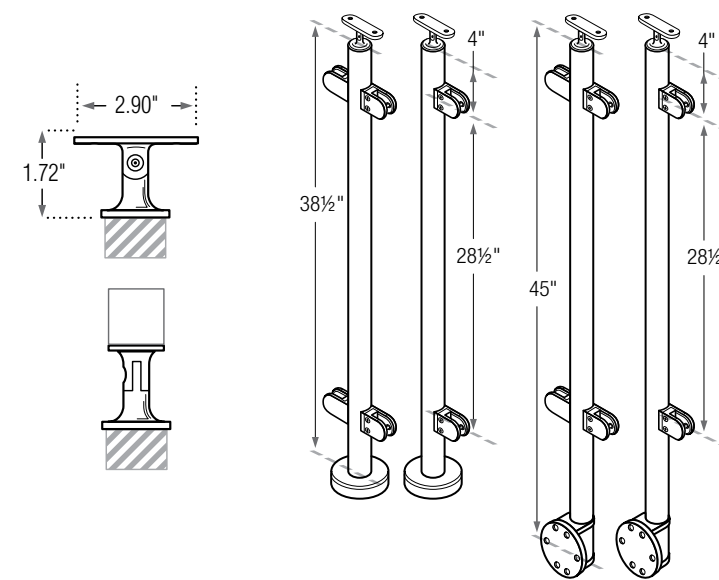

Center, Corner\* and End

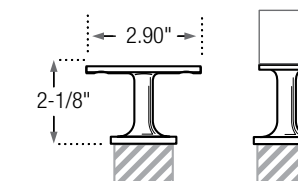
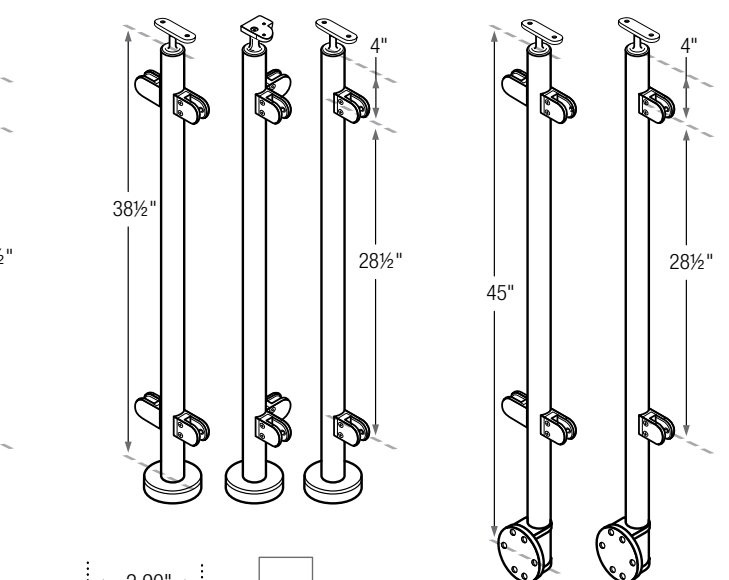

\*Corner saddle also works with short adjustable saddle.

# Wet-Glaze Aluminum Shoe Moulding

Freestanding, frameless Glass Railing Systems offer a classically modern look to your project. The traditional, wet-glaze installation method is a tried and true process that firmly secures the glass into the aluminum base shoe. Mount the shoe directly to the floor or side mount as a fascia-mount.

Add the finishing touch to your Glass Railing project by adding a Channel Tubing handrail. We offer all the necessary components to make installation a breeze.

## Aluminum Shoe Moulding for 1/2" Glass

Creates a clean look in Glass Railing.

ITEM #	MATERIAL	PRE-DRILLED HOLES	LENGTH
50-A123B/20	Aluminum	none	20'
50-A123B/DR/20	Aluminum	yes	20'
50-A123B/CB/20	Aluminum	counter-bored	20'

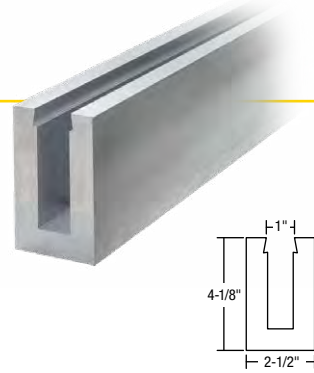

### Pre-drilled Hole Sizes

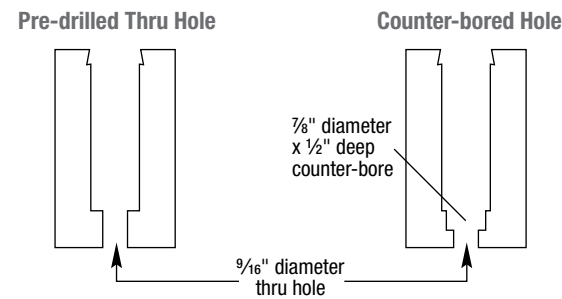

### Pre-drilled Hole Locations

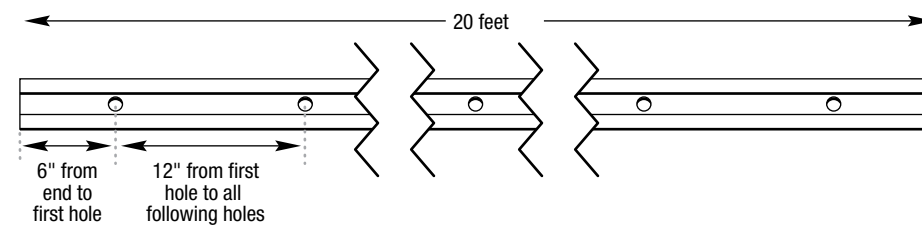

## Solid Stainless Steel Cladding

Creates a finished look for the mill-finish aluminum shoe.

ITEM #	MATERIAL	FINISH	LENGTH
47-CLD04/10	316 Stainless Steel	Polished	10'
49-CLD04/10	316 Stainless Steel	Satin	10'

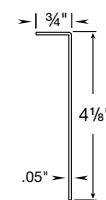

## Glass Railing Assembly

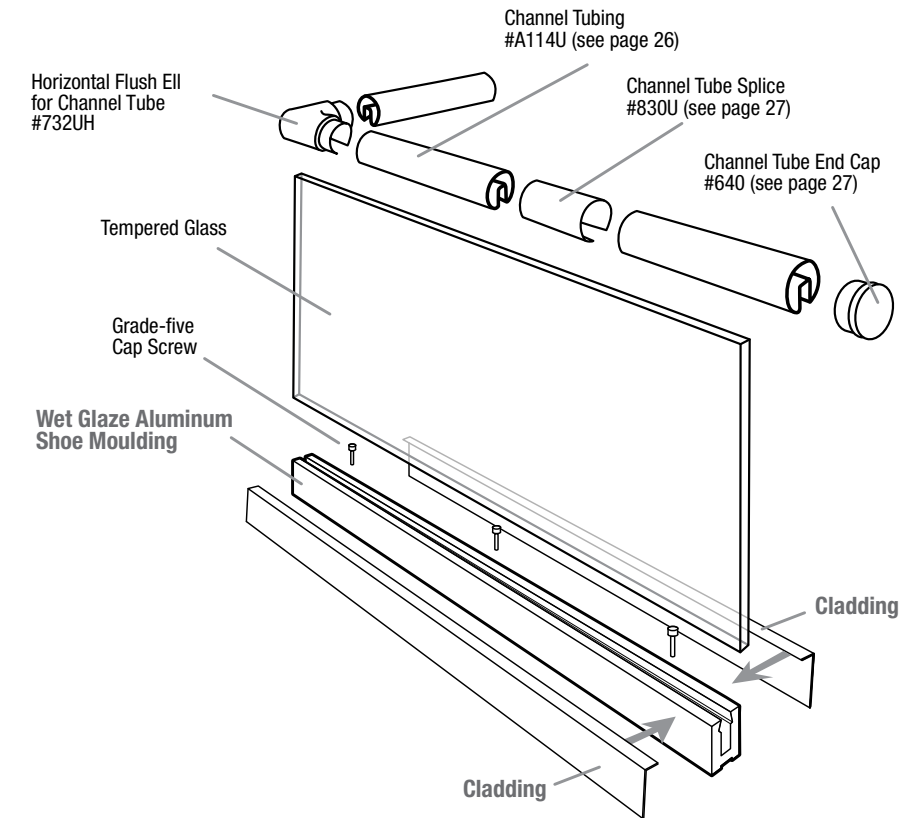

## Mounting Conditions

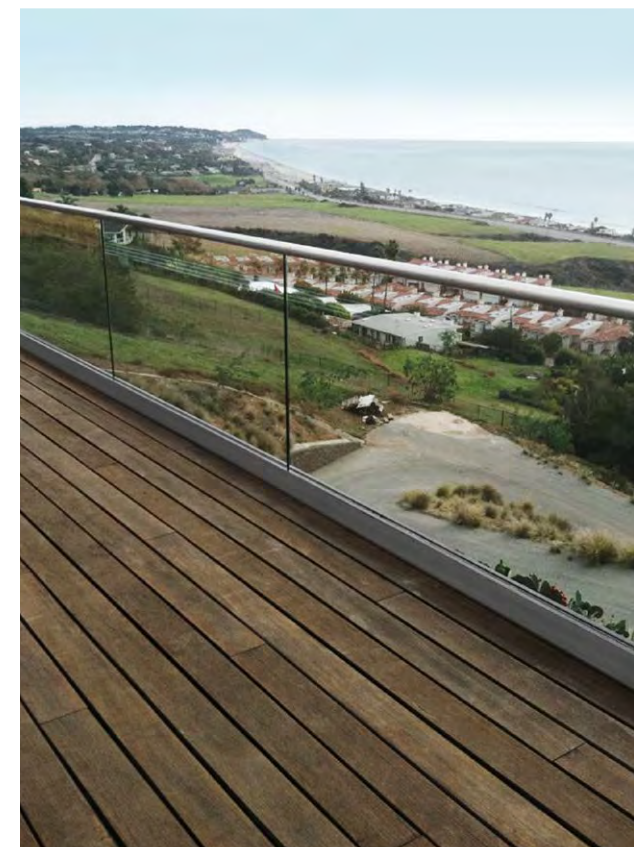
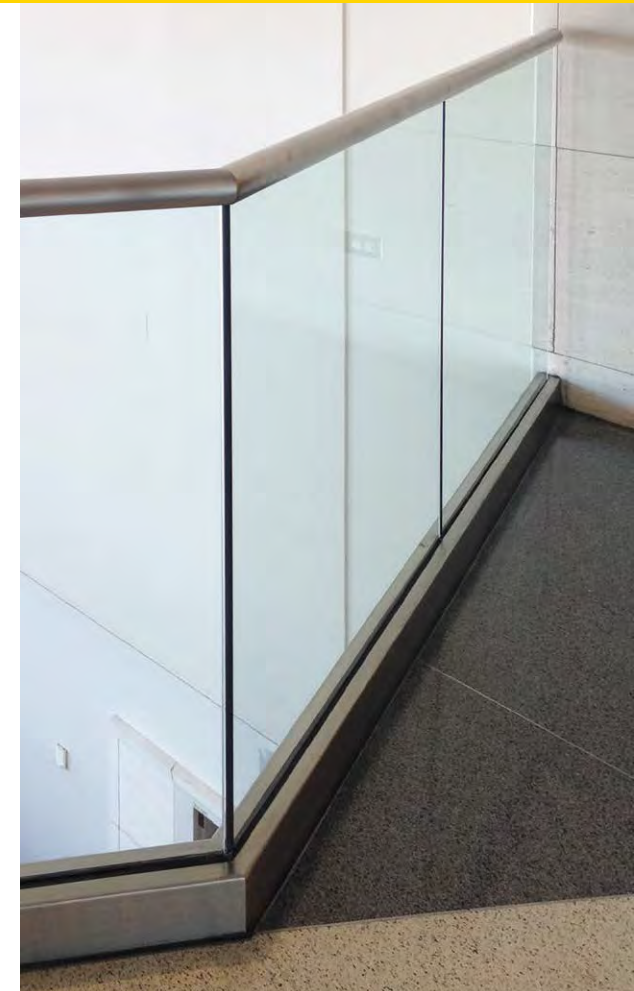
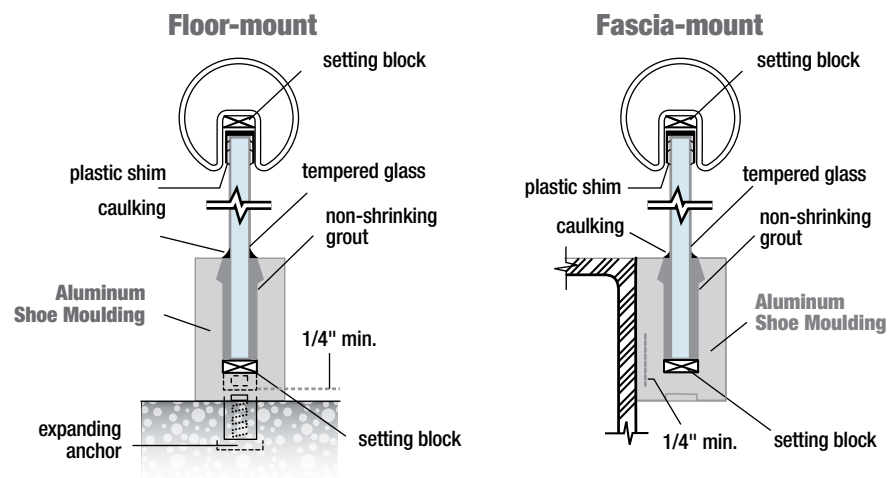

# Channel Tubing

Glass railing offers a clean, elegant and open solution for any environment.

Channel tubing is used to cap the top of the glass panel and gives the railing a finished look.



## Channel Tube

Used to finish the top of glass railing.

ITEM #	MATERIAL	FINISH	OD	WALL THICK	LENGTH	W	D
44-A114U/16	304	Satin	1.67"	0.06"	16'	0.94"	0.94"
40-A114U/16	304	Polished	1.67"	0.06"	16'	0.94"	0.94"
49-A114U/16	316	Satin	1.67"	0.06"	16'	0.94"	0.94"
47-A114U/16	316	Polished	1.67"	0.06"	16'	0.94"	0.94"

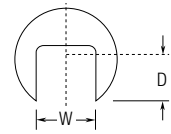

## Channel Tube Insert

Used to secure glass inside a Channel Tube.

ITEM #	MATERIAL	GLASS THICK	LENGTH
85-CTI1002	Rubber	1/2"	100'
85-CTI1003	Rubber	3/4"	100'

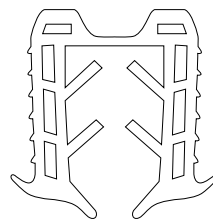

# Channel Tube Fittings

## Horizontal Flush Ell for Channel Tube

Connects channel tube in 90° angle horizontally.

ITEM #	MATERIAL	FINISH	TUBE	WALL THICK	W	L
49-732UH/424	316	Satin	1.67	0.06"	2.03"	2.03"
47-732UH/424	316	Polished	1.67	0.06"	2.03"	2.03"

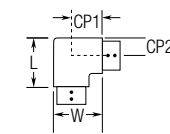

## Vertical Flush Ell for Channel Tube

Connects channel tube in 90° angle vertically.

ITEM #	MATERIAL	FINISH	TUBE	WALL THICK	W	L
49-732UV/424	316	Satin	1.67	0.06"	1.97"	1.97"
47-732UV/424	316	Polished	1.67	0.06"	1.97"	1.97"

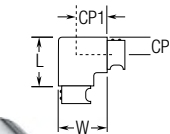

## Channel Tube Splice

Connects channel tube in a straight line.

ITEM #	MATERIAL	FINISH	TUBE	WALL THICK	W
49-830U/424	316	Satin	1.67"	.06"	0.24"
47-830U/424	316	Polished	1.67"	.06"	0.24"

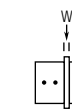

## Channel Tube End Cap

Closes the end of a channel tube.

ITEM #	MATERIAL	FINISH	TUBE	WALL THICK	D	H
49-640/424	316	Satin	1.67"	.06"	1.67"	0.16"
47-640/424	316	Polished	1.67"	.06"	1.67"	0.16"

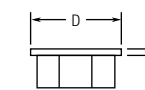

Specially designed to fit with glass channel tube, these fittings add a design dimension to the standard linear aspect of glass railing. In addition to the tight fit, each fitting has threaded screw bosses for a more secure connection.

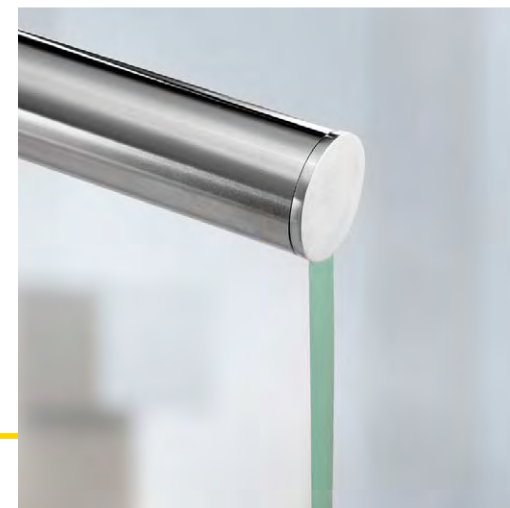

# Glass Grips

## Square Glass Grips

ITEM #	MATERIAL	FINISH	W	H	D	GLASS THICKNESS	MOUNTS ON TO
<b>SMALL GRIPS</b>							
49-850S/F	316	Satin	1.7"	1.7"	.94"	1/4" or 3/8"	Flat Surface
47-850S/F	316	Polished	1.7"	1.7"	.94"	1/4" or 3/8"	Flat Surface
49-850S/1H	316	Satin	1.7"	1.7"	.94"	1/4" or 3/8"	1.5" Tube
47-850S/1H	316	Polished	1.7"	1.7"	.94"	1/4" or 3/8"	1.5" Tube

ITEM #	MATERIAL	FINISH	W	H	D	GLASS THICKNESS	MOUNTS ON TO
<b>LARGE GRIPS</b>							
49-860S/F	316	Satin	2.13"	2.13"	1.3"	3/8" or 1/2"	Flat Surface
47-860S/F	316	Polished	2.13"	2.13"	1.3"	3/8" or 1/2"	Flat Surface
49-860S/424	316	Satin	2.13"	2.13"	1.3"	3/8" or 1/2"	1.67" Tube
47-860S/424	316	Polished	2.13"	2.13"	1.3"	3/8" or 1/2"	1.67" Tube

## Radius Glass Grips

ITEM #	MATERIAL	FINISH	W	H	D	GLASS THICKNESS	MOUNTS ON TO
<b>SMALL GRIPS</b>							
49-850R/424	316	Satin	1.5"	1.93"	1"	1/4" or 3/8"	1.67" Tube
47-850R/424	316	Polished	1.5"	1.93"	1"	1/4" or 3/8"	1.67" Tube
<b>MEDIUM GRIPS</b>							
49-851R/F	316	Satin	1.7"	2.32"	1.02"	1/4" or 3/8"	Flat Surface
47-851R/F	316	Polished	1.7"	2.32"	1.02"	1/4" or 3/8"	Flat Surface
49-851R/1H	316	Satin	1.7"	2.32"	1.02"	1/4" or 3/8"	1.5" Tube
47-851R/1H	316	Polished	1.7"	2.32"	1.02"	1/4" or 3/8"	1.5" Tube
49-851R/424	316	Satin	1.7"	2.32"	1.02"	1/4" or 3/8"	1.67" Tube
47-851R/424	316	Polished	1.7"	2.32"	1.02"	1/4" or 3/8"	1.67" Tube
49-852R/424	316	Satin	1.7"	2.32"	1.15"	3/8" or 1/2"	1.67" Tube
47-852R/424	316	Polished	1.7"	2.32"	1.15"	3/8" or 1/2"	1.67" Tube
<b>LARGE GRIPS</b>							
49-860R/F	316	Satin	2.12"	2.36"	1.3"	3/8" or 1/2"	Flat Surface
47-860R/F	316	Polished	2.12"	2.36"	1.3"	3/8" or 1/2"	Flat Surface
49-860R/2	316	Satin	2.12"	2.63"	1.3"	3/8" or 1/2"	2" Tube
47-860R/2	316	Polished	2.12"	2.63"	1.3"	3/8" or 1/2"	2" Tube

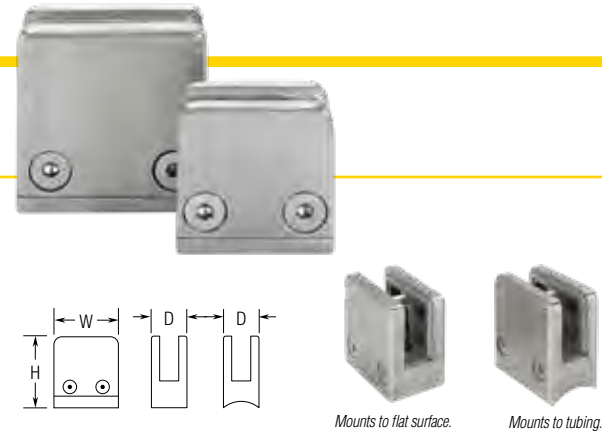

## Rubber Inserts

ITEM #	USE WITH	GLASS THICKNESS
85-GGI1003	Small Grips	1/4"
85-GGI1004	Small Grips	3/8"
85-GGI1005	Large Grips	3/8"
85-GGI1006	Large Grips	1/2"

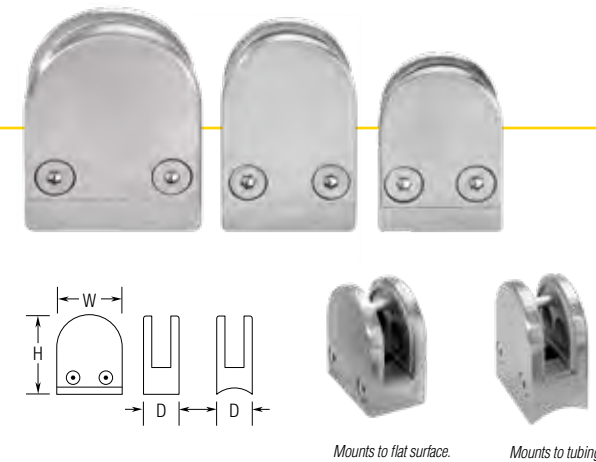

## Rubber Inserts for Radius Glass Grips

ITEM #	USE WITH	GLASS THICKNESS
85-GGI1007	Small Grips	1/4"
85-GGI1008	Small Grips	3/8"
85-GGI1009	Medium Grips	1/4"
85-GGI1010	Medium Grips	3/8"
85-GGI1015	Medium Grips	1/2"
85-GGI1013	Large Grips	3/8"
85-GGI1011	Large Grips	1/2"

## Round Glass Grips

ITEM #	MATERIAL	FINISH	W	H	D	GLASS THICKNESS	MOUNTS ON TO
<b>CENTER GRIPS</b>							
49-846C/F	316	Satin	2.30"	2.30"	1/2"	1/2"	Flat Surface
49-846C/424	316	Satin	2.30"	2.30"	1/2"	1/2"	1.67" Tube
<b>END GRIPS</b>							
49-846E/F	316	Satin	2.30"	2.30"	1/2"	1/2"	Flat Surface
49-846E/424	316	Satin	2.30"	2.30"	1/2"	1/2"	1.67" Tube

## Rubber Inserts for Round Glass Grips

ITEM #	USE WITH	GLASS THICKNESS
85-GGI1002	Round Grips	1/2"

## Universal Round Glass Grip

ITEM #	MATERIAL	FINISH	D	H	MOUNTS TO
49-842/F	316	Satin	Up to 1/2"	1.57"	Flat Surface
49-842/424	316	Satin	Up to 1/2"	1.57"	1.67"-diameter tube

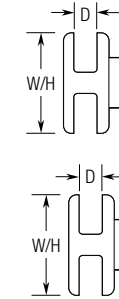
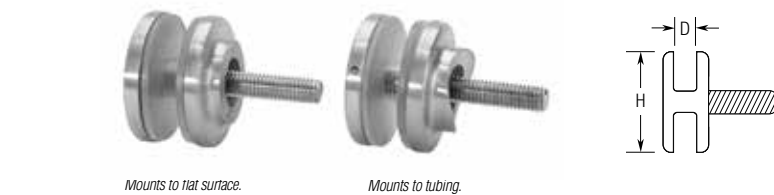

Rubber Inserts come in pairs.

Mounts to flat surface. Mounts to tubing.



## End Caps and Finials

Finial options allow the end of a tube to be safely sealed. Radius wall returns offer the ability to wrap wall-mounted rail towards the wall. Flush end caps are designed to fit in by pressure: simply use a rubber hammer to hit the piece into place.

### End Caps

Flush End Cap provides a clean, flat end for tubing.

ITEM #	MATERIAL	FINISH	WALL THICK	D	H
49-600/1H16	316	Satin	0.06"	1.5"	0.13"
47-600/1H16	316	Polished	0.06"	1.5"	0.13"
49-600/216	316	Satin	0.06"	2"	0.13"
47-600/216	316	Polished	0.06"	2"	0.13"

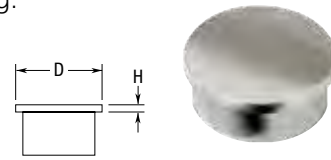

Knurled End Cap creates a flat, finished end for tubing. The knurled texture on the neck provides a secure pressure fit.

ITEM #	MATERIAL	FINISH	WALL THICK	D	H
49-600PF/424	316	Satin	.08"	1.67"	0.14"
47-600PF/424	316	Polished	.08"	1.67"	0.14"
49-600PF/1H16	316	Satin	.06"	1.5"	0.14"
47-600PF/1H16	316	Polished	.06"	1.5"	0.14"
49-600PF/216	316	Satin	.06"	2"	0.14"
47-600PF/216	316	Polished	.06"	2"	0.14"

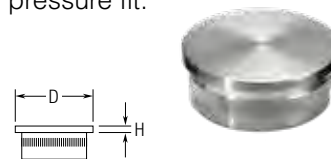

Half-ball Rounded End Cap creates a rounded, finished end for tubing.

ITEM #	MATERIAL	FINISH	WALL THICK	D	H
49-602/424	316	Satin	0.08"	1.67"	0.83"
47-602/424	316	Polished	0.08"	1.67"	0.83"
49-602/216	316	Satin	0.06"	2"	0.06"
47-602/216	316	Polished	0.06"	2"	0.06"

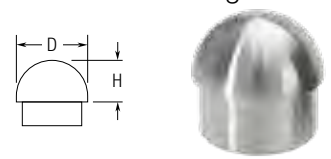

### Ball Finial

Decorative ball that closes the end of a vertical or horizontal tube.

ITEM #	MATERIAL	FINISH	TUBE	WALL THICK	H	D
49-604/424	316	Satin	1.67"	0.08"	4.09"	2.75"
47-604/424	316	Polished	1.67"	0.08"	4.09"	2.75"
49-604/1H16	316	Satin	1.5"	0.06"	4.05"	2.75"
47-604/1H16	316	Polished	1.5"	0.06"	4.05"	2.75"
49-604/216	316	Satin	2"	0.06"	4.55"	3.08"
47-604/216	316	Polished	2"	0.06"	4.55"	3.08"

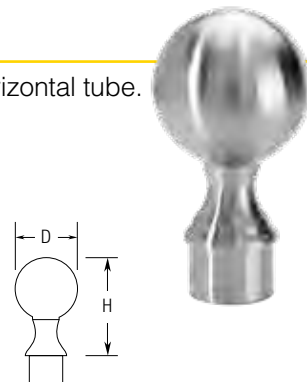

### Radius Wall Return

For details, please see page 33.



## Tubing

ITEM #	MATERIAL	FINISH	OD	WALL THICK	LENGTH
49-A111/20	316	Satin	1.5"	0.06"	20'
47-A111/20	316	Polished	1.5"	0.06"	20'
49-A113/20	316	Satin	1.5"	0.125"	20'
49-A114/20	316	Satin	1.67"	0.08"	20'
47-A114/20	316	Polished	1.67"	0.08"	20'
49-A121/20	316	Satin	2"	0.06"	20'
47-A121/20	316	Polished	2"	0.06"	20'



## Adhesive and Polish

ITEM #	PRODUCT	DESCRIPTION
00202	Metal Polish	Polish
00201	Loctite 326	Adhesive
00211	Loctite 7649	Primer
00203	MAAS Stainless Steel Cleaner	Cleaner
00204	MAAS Polishing Cloth	Cloth

