

# The High-Security Series

Full-Height Turnstile (Single) • Interior & Exterior Application

HS427-S • HS430-S

HS439-S • HS448-S

www.TURNSTILES.us distributes the most reliable full-height turnstiles available. Our High-Security Series units can be engineered to meet all your security and control requirements, and can be created as stand-alone units, or as part of an integrated system. Available in stainless steel, powder coat or a hot-dipped galvanized finish, these units can be fitted for any application with leading edge technology and features.

## Controls and Interfaces

- Biometric Integration
- Card Readers
- Electronic/LCD Counters
- Metal Detection
- Fail-Open or Fail-Secure Locking
- Push-Button and Wireless Remotes
- Manual Key Override – both directions
- Indicator Lights



## Size Options (pedestrian clearance):

- HS427-S: 27" (686mm)
- HS430-S: 30" (762mm)
- HS439-S: 39" (991mm)
- HS448-S: 48" (1219mm)

304 Stainless,  
No.4 Satin finish (shown)

Also available in  
hot-dipped galvanized or  
powder coat finishes.

	Depth	Width	Passage Width	Passage Height	Overall Height
	A*	B*	C*	D*	E*
HS427-S	54" 1372mm	62" 1575mm	27" 686mm	84" 2134mm	91" 2311mm
HS430-S	56" 1422mm	66" 1676mm	30" 762mm	84" 2134mm	91" 2311mm
HS439-S	68" 1727mm	84" 2134mm	39" 990mm	84" 2134mm	91" 2311mm
HS448-S	93" 2362mm	106" 2692mm	48" 1219mm	84" 2134mm	91" 2311mm

\* See CAD drawings on reverse side.

8641 South Warhawk Road Conifer, CO 80433  
(303) 670-1099 Patrick.McAllister@TURNSTILES.us



# The High-Security Series

HS4210-S • HS430-S

HS439-S • HS448-S

## Full-Height Turnstile (Single) • Interior & Exterior Application

### Applications:

Ideal for controlling orderly flow of foot traffic in both indoor and outdoor settings

### Product Features:

Materials and Finishes available in your choice of:

- Hot dipped galvanized carbon steel
- Polyester enamel on carbon steel (standard color is black/ other colors available upon request)
- Our signature 304 Stainless steel/ No.4 satin finish

### Design & Construction:

- Designed for secure operation with aesthetics in mind
- Featuring fully welded exterior components
- Minimal exposed hardware
- Heavy gauge materials meeting ASTM standards

### Controller &

#### Access Control Operation:

- Self-centering control head with adjustable hydraulic shock suppression
- Hardened tool steel locking bars, cam and roller assemblies
- Permanently lubricated bearings
- All units are available in clockwise, counter-clockwise or bi-directional passage

### Measures: HS427-

S

Size of opening (pedestrian clearance)  
HS427-S 27" (686mm)

#### Arm and Barrier Tubing Sizes

1 1/2" diameter 14 gauge (38mm) - Standard  
1 3/4" diameter 14 gauge (44mm) - Optional  
Width                      Depth  
62" (1575mm)              54" (1372mm)

### HS430-S

Size of opening (pedestrian clearance)  
HS430-S 30" (762mm)

#### Arm and Barrier Tubing Sizes

1 1/2" diameter 14 gauge (38mm) - Standard  
1 3/4" diameter 14 gauge (44mm) - Optional  
Width                      Depth  
66" (1676mm)              56" (1422mm)

### Measures: (continued)

#### HS439-S

Size of opening (pedestrian clearance)  
HS439-S 39" (991mm)

#### Arm and Barrier Tubing Sizes

1 3/4" diameter 14 gauge (44mm)  
Width                      Depth  
84" (2134mm)              68" (1727mm)

#### HS448-S

Size of opening (pedestrian clearance) HS448-S 48" (1219mm)

#### Arm and Barrier Tubing Sizes

1 3/4" diameter 14 gauge (44mm)  
Width                      Depth  
106" (2692mm)              93" (2362mm)

### All models:

- Overall exterior height 91" (2311mm)
- Pedestrian walk through height 84" (2134mm)

### Options:

- Electronic locking module featuring heavy-duty 24 vdc pull-type industrial solenoids and card reader interface
- Available in Fail-Safe (open on power failure) or Fail-Lock (lock on power failure modes)
- Can interface with card readers, computer attendance systems, coin and token acceptors, push buttons, wireless remote controls and metal detectors
- Electronic 6 digit resetable counter with LCD display and ten-year lithium battery
- Vertical Graphic Array (VGA) red x / green arrow
- Additional options available on request

Matching Swing Gate available (see model HS336 Manual Passage Gate information)

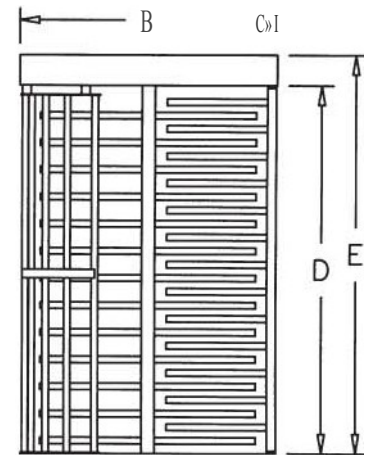
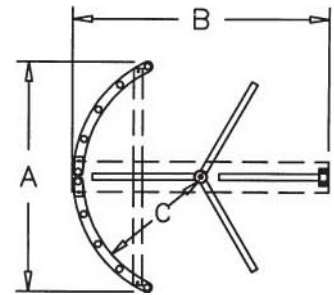

Electrical Specifications:  
Command module input 110-240 VAC (2 amp-1 amp) 50-60 Hz; control voltage 24 V0E. All electrical components are UL recognized and CSA certified.

### Standards and Codes:

Austenitic stainless steel:  
ASTM A240, A249, A276  
Hot rolled steel:  
AISI C-1020, AISI C-1018  
Hot dipped galvanizing:  
ASTM A-143, ASTM A-153-80  
Stainless steel fasteners:  
ASTM A-320  
American Welding Society (AWS)  
Standard D 1.1



Pricing:

FULL HEIGHT MODEL		COST EA
<b>Single Full Heights</b>		
HS427-FW (450 lbs.)		\$3,499
HS427-S-GV (450 lbs.)		\$4,041
HS427-S-PC (450 lbs.)		\$4,423
HS427-S-SS (450 lbs.)		\$8,176
HS427-S-GV-HD (630 lbs.)		\$4,793
HS427-S-PC-HD (630 lbs.)		\$5,176
HS427-S-SS-HD (630 lbs.)		\$8,982
HS430-S-GV (600 lbs.)		\$4,127
HS430-S-PC (600 lbs.)		\$4,827
HS430-S-SS (600 lbs.)		\$8,474
HS430-S-GV-HD (700 lbs.)		\$4,880
HS430-S-PC-HD (700 lbs.)		\$5,461
HS430-S-SS-HD (700 lbs.)		\$9,280
HS439-S-GV (700 lbs.)		\$6,070
HS439-S-PC (700 lbs.)		\$6,821
HS439-S-SS (700 lbs.)		\$12,461
HS448-S-GV (950 lbs.)		\$12,842
HS448-S-PC (950 lbs.)		\$12,842
HS448-S-SS (950 lbs.)		\$17,308
<b>Tandem Full Heights</b>		
HS427-T-GV (1050 lbs.)		\$9,967
HS427-T-PC (1050 lbs.)		\$11,016
HS427-T-SS (1050 lbs.)		\$18,580
HS427-T-GV-HD (1470 lbs.)		\$11,472
HS427-T-PC-HD (1470 lbs.)		\$12,523
HS427-T-SS-HD (1470 lbs.)		\$20,190
HS430-T-GV (1100 lbs.)		\$10,055
HS430-T-PC (1100 lbs.)		\$11,104
HS430-T-SS (1100 lbs.)		\$19,177
HS430-T-GV-HD (1540 lbs)		\$11,561
HS430-T-PC-HD (1540 lbs)		\$12,610
HS430-T-SS-HD (1540 lbs)		\$20,786
<b>Full Height ADA Gates</b>		
HS336-ADA-GV (220 lbs.)		\$3,672
HS336-ADA-PC (220 lbs.)		\$3,848
HS336-ADA-SS (220 lbs.)		\$5,582
HS336-ADA-GV-HD (308 lbs.)		\$3,895
HS336-ADA-PC-HD (308 lbs.)		\$4,072

<b>Controls and Functionality <u>ALL MODELS</u> (except HS336)</b>		
<b>Manual Control Head</b>	Operates Manually both ways	0
<b>Electronic Control Head (1 or 2 direction)</b>	Can be electronic one or both directions	505
<b>Proximity Sensor Upgrade</b>	Contactless switches for control longevity	390
<b>Home Position Switch</b>	Provides a dry contact when unit is closed	26
<b>Key Override (both directions only)</b>	Available bi-directionally only, fail lock not available on ADA models (except Brute series)	
<b>Serial interface Port Converter</b>	Provides an override to turnstile functionality.	250
		387
<b>Full Height Turnstile Options</b>		
<b>Card Reader Mounting Plates (1/electronic direction)</b>	For mounting most standard card readers	60
<b>End Caps (Quantities: 52/single turnstile, 104/tandem)</b>		
<b>End cap for HS427 &amp; HS430 models (each)</b>	Black, 1.25 diameter	2
<b>End cap for HS439 and HS448 models (each)</b>	Black, 1.75 diameter	2
<b>Heel Guards - for HS427 &amp; HS430 models (each)</b>	Black, 1.5" Diameter (sold individually)	17
<b>Heel Guards - for HS439 &amp; HS448 models (each)</b>	Black, 1.75" Diameter (sold individually)	35
<b>Full Canopies (see TURNSTILES.us website)</b>	Full Canopies with Gutter	Web
<b>Hinged Cover</b>	Use where limited clearance exists	361
<b>Split Cover</b>	Use where limited clearance exists	361
<b>Cold Weather Package</b>	Heater & mainframe insulation (in cover)	540
	Galvanized base plate (for portability of unit)	1200
<b>Full Height ADA GATE Options</b>		
Full panic bar with reach prevention mesh	For "Free Exit" units, order Full Panic Bar w/mesh	723
Motorized door opener (with mounting bracket)		4000
ADA placard button & mounting case		270
<b>Finish Options (Full Ht. Turnstile &amp; ADA Gate Only)</b>		
<b>Powder coating standard colors: black, silver, almond</b>		n/c
<b>Powder coating over galvanizing</b>		745
<b>Special powder coating colors</b>	Custom Quoted	TBD